



铜泵头  
BRASS HEAD



铝合金连杆  
CONNECTING-RODS  
IN ALUMINIUM

RC



## 320 Series

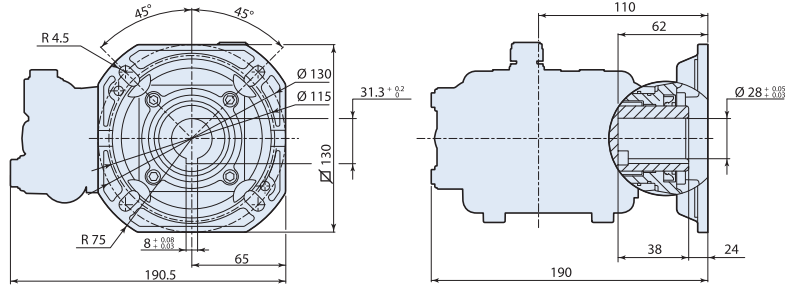

型号	流量 Flow		压力 Pressure		电机功率 Power		重量 Weight	转速 RPM	温控阀 TRV	进水口 Inlet	出水口 Outlet	编号 Code
	l/min	gpm	bar	psi	hp	kw	kg	rpm	TRV			

### RC 1450 转 C 轴 28mm 空心轴 + F44 法兰 - 适用于电机 MEC 100 - 112

RC 06.17 C+F44	6	1.60	170	2500	3.0	2.2	5.5	1450	无	1/2"GF	3/8"GF	24560
RC 11.17 C+F44	11	2.90	170	2500	5.0	3.6	5.5	1450	无	1/2"GF	3/8"GF	24800
RC 12.10 C+F44	12	3.20	100	1450	3.0	2.2	5.5	1450	无	1/2"GF	3/8"GF	23902
RC 13.17 C+F44	13	3.43	170	2500	5.5	4.0	5.5	1450	无	1/2"GF	3/8"GF	23535
RC 14.16 C+F44	14	3.70	160	2300	5.5	4.0	5.5	1450	无	1/2"GF	3/8"GF	23536

Model	Flow		Pressure		Power		Weight	RPM	TRV	Inlet	Outlet	Code
	l/min	gpm	bar	psi	hp	kw	kg	rpm	TRV			

### RC 1450 RPM C Version 28mm hollow shaft with flange F44 for el. motors MEC 100-112

RC 06.17 C+F44	6	1.60	170	2500	3.0	2.2	5.5	1450	No	1/2"GF	3/8"GF	24560
RC 11.17 C+F44	11	2.90	170	2500	5.0	3.6	5.5	1450	No	1/2"GF	3/8"GF	24800
RC 12.10 C+F44	12	3.20	100	1450	3.0	2.2	5.5	1450	No	1/2"GF	3/8"GF	23902
RC 13.17 C+F44	13	3.43	170	2500	5.5	4.0	5.5	1450	No	1/2"GF	3/8"GF	23535
RC 14.16 C+F44	14	3.70	160	2300	5.5	4.0	5.5	1450	No	1/2"GF	3/8"GF	23536